



The State of Exclusivity & Fascination

Thailand

"The Land of Smiles"



The crowning jewel of Southeast Asia, Thailand's rich culture, exotic atmosphere and openness to international initiatives makes it the perfect location for MICE and leisure. A country with diverse attractions, it is the land of golden temples and tropical beaches.

The Royal Cliff Hotels Group is the epitome of Thai traditions combined with modern values and continual progress.

C o n t e n t s

01	The Ideal Choice for MICE
03	Top Reasons for Choosing the Royal Cliff Hotels Group and PEACH
05	Royal Cliff Hotels Group <ul style="list-style-type: none">- Philosophy- Testimonials- Awards- Our Partners- Diversity
11	Pattaya Exhibition And Convention Hall (PEACH)
13	MICE Services <ul style="list-style-type: none">- Overview- Meetings & Conferences- Incentives- Team Building- Exhibitions- Weddings- Themed Dinners- Spouse & Family Programmes- Floor Plans & Dimensions
31	Accommodations
33	Restaurants & Bars
35	Recreational Activities
36	Health and Wellness
37	International Benefits
37	Safety & Security
38	Special Needs Services
39	Pattaya, Thailand
39	Local Attractions
45	Essential Facts
47	Total Functions and Meeting Venues
49	Notes
55	Contact Information



Pattaya is one of the top MICE cities in Thailand. This destination offers the best hotels, restaurants, entertainment, attractions and shopping facilities.

The Ideal Choice for MICE

Royal Cliff Hotels Group is set upon a tropical mountainside surrounded by scenic views of the Gulf of Thailand. This resort convention offers spectacular views of both the mountain and the ocean. Comprising 4 luxury hotels of 5-star standards offering 1,020 rooms and suites, 11 restaurants, 6 bars, a host of facilities and the multi-purpose award-winning convention centre, Pattaya Exhibition And Convention Hall (PEACH), it is one of the few properties in Thailand that can truly offer MICE planners and event organizers a complete and integrated meeting solution. All the facilities are within 5 minutes walking distance.

As a premier meeting, incentive, convention and exhibition destination, the Royal Cliff Hotels Group has a long and admirable record of hosting some of the most notable political and business meetings in the region. In 1991, we hosted the Cambodian peace talks; 6 years later, we were the venue for drafting the new Thai constitution; and in 2003, we hosted the APEC Tourism Working Group, which was attended by senior tourism officials from 21 member countries. We also hosted the ASEAN Summit in 2009 with Heads of States from the 10 ASEAN countries and other Asian nations in attendance which made headlines around the world.

Other significant events that have taken place here include the 55th Pacific Asia Travel Association (PATA) Conference, the 46th International Congress & Convention Association (ICCA) Conference, the star-studded 23rd Subhanahongsa National Film Awards, Go Diamond Asia Pacific 2014, Asia Petrochemical Industry Conference (APIC) 2014 and the 48th Southeast Asian Ministers of Education Organization (SEAMEO) Council Conference. We offer MICE planners flexibility along with extensive convention and meeting space. We host dynamic, motivating and rewarding engagements.

Conducting business in an environmentally-friendly way is at the heart of the organization. We support and pioneer green initiatives and take this a step further by encouraging event organisers to do the same. We have launched an exciting tree planting program where Flame trees would be planted in various vital locations on behalf of the companies and organizations who select the Royal Cliff Hotels Group and PEACH as the venue for their events. Organization representatives are awarded a tree planting certificate that shows their support for our long-lasting commitment to environmental sustainability. Also, as PEACH uses energy effectively, by having your event here, you are helping to sustain the environment.

Our multilingual and international team strives to accomplish the highest standards of service through efficiency, attention to detail, personalised service, professional support and outstanding cuisine. We have the infrastructure, technology and exceptional service to ensure that your meetings will always be a successful and a memorable one.

We strive to make every event extraordinary.

We look forward to welcome you and your group to the Royal Cliff and PEACH!



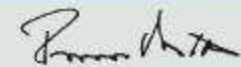

Panga Vathanakul

Managing Director
Royal Cliff Hotels Group

Notes



Top Reasons

to Choose the Royal Cliff Hotels Group and PEACH for Your Event

Easy Accessibility

Pattaya is the closest city to Thailand's major international gateway - Bangkok. Easy to get to, with modern and efficient highways and motorways, the transfer time between the 2 cities is less than 2 hours. It takes just 75 minutes from the Suvarnabhumi Airport to reach the resort city without having to bypass the congested traffic jam in Bangkok. The new U-Tapao-Rayong-Pattaya International Airport is only a 40-minute drive from the Royal Cliff Hotels Group and PEACH. There are also 2 fully licensed helicopter pads located at the Royal Cliff Grand Hotel and PEACH.

Perfect Location

Situated on an exclusive 64-acre estate overlooking the Gulf of Thailand, the Royal Cliff Hotels Group is an oasis of tranquility and comfort. It is only a 5-10 minute drive from the main shopping centre of Pattaya city and its entertainment venues. All the major attractions of Jomtien and Pattaya are within a 30-minute drive.

Dynamic Facilities

PEACH offers meeting organisers a wide range of meeting options. The whole complex can offer 53 different meeting venues measuring over 23,500 square metres with the largest hall having the capacity for 10,062 delegates. We also offer advance technological facilities including video conferencing, web conferencing, teleconferencing, webinars as well as excellent audio and visual systems. It is our aim to create an environment where organisers and business delegates have an opportunity to achieve serious business solutions within a self-sufficient environment. 4 supporting 5-star hotels are within the vicinity of PEACH which have the capacity to accommodate more than 1000 delegates. It is only a 2-minute walk under covered walkways from the hotel rooms to the meeting venues.

Safe & Secure

We have over 100 professional and constantly trained security personnel patrolling the premises on a 24-hour basis. Vehicle entry points into the property are gated and manned whilst movement of people in public areas is monitored around-the-clock through CCTV cameras. In addition, the helipads at PEACH and at the Royal Cliff Grand Hotel, offer another transportation option for VIPs.

Exclusive On-site Events

With 2 private beaches which can also be used for team building and beach volleyball, the Lotus garden, picturesque tropical terraces, numerous poolside settings and spectacular ballrooms, we offer a supplementary range of venues for exclusive events. Themed dinners are available upon request.

Gourmet Cuisine

Our award-winning kitchen team creates exceptional cuisine that infuses the flavours of the east and west. PEACH has a self-sufficient and fully equipped banqueting kitchen which is capable of catering up to 10,000 delegates. Our experienced chefs with their brigade of staff are on hand to ensure that banquets are prepared to perfection. Additionally, with 11 award-winning restaurants including a certified Halal kitchen, delegates have the option to choose from an impressive range of cuisine from around the world!

For large conferences, our Coffee Shop in PEACH can cater to the group. A spacious area of bistro-style set-up offering wholesome meals, buffets, canteen style food as well as snacks can be arranged.

Destination Treasures

Jomtien & Pattaya have an excellent choice of 'destination treasures' where sightseeing can be fun and full of discovery. The sights diversify from beautiful tropical islands within an hour's reach to amazing temples, family theme parks, botanical gardens, variety of zoos, recreational pursuits, entertainment, shopping and cultural activities. Recommended visits would include the stunning Sanctuary of Truth, Art in Paradise, Ramayana Waterpark and Cartoon Network Amazone Waterpark.

Planning Expertise

A distinctive feature of Royal Cliff & PEACH is our highly motivated and well-trained staff that provide attentive service. There are over 1,300 staff who are ready to assist in every way. Whether you are planning a conference, seminar or training session, we can customize our facilities to meet your individual needs. Our dedicated international team of event coordinators, technical experts, experienced engineers and incentive specialists are available to help you create a seamless event.

Green Initiatives

Endorsed as a 'green' property and the pioneer of environmental progress in Pattaya, the Royal Cliff Hotels Group has been championing environmental conservation since 1973. In 2008, we were recognized as "The Best Green Hotel" by The Green Hotels of USA making us the only hotel property in Thailand to achieve this prestigious distinction. For our ongoing efforts to keep a cleaner, greener environment, we have been rewarded with the Environmental Impact Assessment (EIA) Monitoring Award 2009 in recognition of our exceptional environmental management practices. Since 2006, we have consistently received the ISO 14001, an environmental management certification given to organizations that implement strict policies to safeguard the environment and have been recently certified with the ISO 14001:2015.



Fantastic Destination

Pattaya offers beautiful tropical islands within an hour's reach to amazing temples, family theme parks, recreational pursuits, entertainment, shopping and cultural activities.

Notes



ROYAL CLIFF HOTELS GROUP

THE STATE OF EXCLUSIVITY & FASCINATION

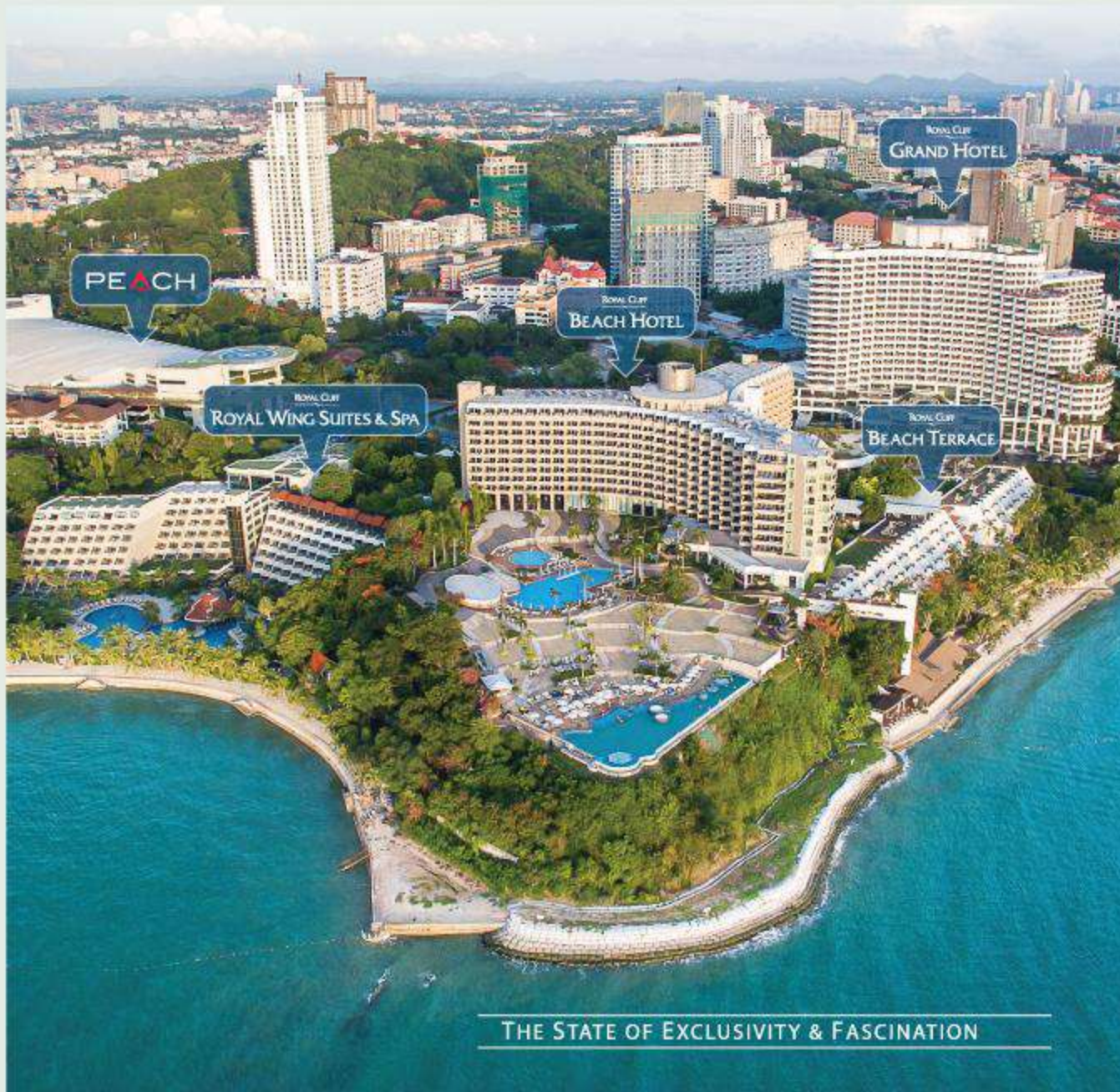

"Within this state of exclusivity and fascination, we will endeavour to provide you with services beyond your expectations, where your utmost comfort, safety, well-being and happiness are our top priorities. Whether it's business or leisure, we aim to offer you with facilities and services that are amongst the best in the world."

Royal Cliff Hotels Group

The Royal Cliff Hotels Group together with Pattaya Exhibition And Convention Hall (PEACH), is an award winning Hotel Group & Convention Centre, the first of its kind in Asia Pacific to be ideally located amidst nature. Situated between Jomtien and Pattaya in a private 64-acre beachside estate overlooking the stunning Gulf of Thailand, we are home to 4 luxury hotels; each offering a sensory experience defined profoundly by its individual style, charm and elegance – presented with the distinctive spirit of the State of Exclusivity and Fascination.

Our team of over 1,300 staff is ready to ensure that every stay is a relaxing, enjoyable and a memorable experience. To achieve this, we have a multilingual team who are extensively and continuously trained. Most importantly, our staff are selected based on their motivation and passion for working in the service industry.

Today, we offer a remarkable synchronised portfolio of services and facilities that consists of 4 hotels, 11 restaurants, 6 bars, 7 swimming pools including 2 infinity edge pools, 2 health spas, beauty salon, a Thai cooking school, kids world, games, pool and karaoke, a state-of-the-art fitness complex, 7 floodlit tennis courts, 2 squash courts, 2 exclusive beaches, a world-class convention and exhibition centre (PEACH), 3 ballrooms, 53 meeting rooms, Wi-Fi technology, in-room IPTV system, shopping arcade and shuttle service to downtown Pattaya.

Philosophy

The Royal Cliff Hotels Group's legendary tradition is as enchanting as the grace and charm of Thailand. The uniqueness of our Thai hospitality and product is beautifully refined with a touch of gracious modernity. Providing our guests with a relaxing and memorable experience is our timeless philosophy which perfectly enthralls with the fabled tale of Phra Apai Mani.

Created by renowned Thai poet, Sunthorn Phu, Phra Apai Mani was a mythical and charming hero who played enchanting melodies using his magical flute. The story tells of his dangerous encounters with the monsters of the deep. When he played his remarkable flute, the entrancing music was so mesmerising that the monsters were enveloped into the spell of the enchanting tunes. His charm and charisma attracted many maidens and mermaids during his perilous journey.

Phra Apai Mani is our symbol of strength, poise and charisma and just like his captivating charm along with his extraordinary magical flute, we embrace the ageless promise of a safe haven. Upon entering the State of Exclusivity and Fascination, all our valued guests and visitors are assured of a delightful and enchanting experience.



Royal Cliff Hotels Group

Just like Phra Apai Mani's captivating charm along with his extraordinary magical flute, we embrace the ageless promise of a safe haven.

Notes

Testimonials

The Royal Cliff Hotels Group and PEACH constantly receive positive and encouraging comments from top business executives, event organisers and delegates, as well as regular guests who endorse our exceptional facilities and services.



“ This is the first time for us to have our annual meeting at the Royal Cliff Hotels Group and our association is delighted with the hotel's accommodations, services and meeting facilities. We were also impressed with its ideal location and the delicious food we experienced. Next year, we truly hope that we will be able to have this important event for us in this hotel again. ”

Dr. Teerapong Tantawichien, President

Infectious Disease Association of Thailand



“ This is the first time that I have organized this symposium in such a huge property. This year we are delighted to have 17 prominent international speakers and 12 top experts from Thailand for our symposium. We like the warm atmosphere and appreciate the excellent service from the very helpful staff. All my friends are just amazed with the quality of the facilities and the beauty of this location. My colleagues and I are impressed with the hospitality we have received here and look forward to our return. ”

Dr. Taweesak Chotivatanapong, Chairman

Organizing Committee of the 5th CDI – Heart International Symposium and the Department of Cardiothoracic Surgery Chest Disease Institute in Nonthaburi, Thailand



“ With its spacious state of the art facilities and superb customer service, the award-winning Pattaya Exhibition And Convention Hall (PEACH) was once again the organization's chosen venue for this year's exciting event. PEACH has it all when it comes to handling our needs and requirements. As our event has been constantly growing every year, we require a spacious venue and high standard facilities to be able to support our growing number of participants. PEACH never fails to support us in any of these aspects. In addition, our members also have the convenience of experiencing excellent and very comfortable accommodations on-site, with a choice of staying at any of Royal Cliff's four 5-star hotels. ”

Mr. Krit Pasit, Vice President

Member Relationship Management of the Thailand Electrical & Mechanical Contractors Association (TEMCA)



“ Pattaya Exhibition And Convention Hall together with Royal Cliff Hotels Group is a world-class facility. This unique venue can offer organizers and MICE planners a totally integrated solution where everything is taken care of. If you are looking for luxury and variety, this is the ideal place. Another feature I love about this property is that it offers different hotels catering to different needs and all the hotels including the convention centre are within the same site. Furthermore, the resort is very close to the best golf courses in Thailand. ”

Peter Walton, IAGTO's President

Asia Golf Tourism Convention (AGTC)



“ It's my first time here at the Royal Cliff and Pattaya Exhibition And Convention Hall. The facilities are amazing. They are modern and up-to-date. They offer an impressive venue for the symposium that is truly world-class with very helpful staff. I love how convenient it is for us to just walk from our rooms in the hotel to the convention center. The hotel itself is magnificent and it is such a great pleasure to be here. ”

Dr. Patrick Perier, Cardiac Surgeon

Herz und Gefäß Klinik (Bad Neustadt/Saale), Germany

“ The staff provided excellent service. They did the job so quickly and with a service mind. Although they had to work until late at night and start their job very early, none of them showed signs of annoyance or anger. They always made sure to do all their best to take care of us. Every request was done accordingly. Everyone in my team, my customers as well as my boss were very impressed with the service and we will definitely return. As the event representative, I am thanking the team for their hard work in taking care of me and my event. I can feel that my needs are their top priorities and they even worked overtime to make sure that everything was perfect. The hotel is very lucky to have such excellent staff. There was also a very nice housekeeper who came early everyday to take care of our group providing excellent service. As for F & B, the food was very tasty, even the food in the food court was worth every baht. This exceeded our expectations. The party was excellent as well. Please convey my compliments to the chefs. ”

Lalita Sansukthawesap, Sales & Event Representative

Herbal Life, Thailand

“ Royal Cliff Hotels Group and PEACH are very well known worldwide. They have a reputation for providing services that exceed customer expectations. Unlike other exhibition halls that have a lot of restrictions; PEACH provides flexibility and convenience that help ensure the spontaneity and success of our event. Every time we use PEACH as our venue, we are always highly satisfied with everything, from the exemplary services provided by their amazing staff, the delicious food, wonderful accommodations, to their unlimited and relentless support to our organizers. ”

Mr. Vithaya Charmanich, Chief Agency Officer

Krungthai-AXA Life Insurance Public Company Limited

“ PEACH, as a one stop shop convention center, is the perfect venue for exhibitions and can hold any kind of event. It is very convenient to go from our hotel to the exhibition hall because of the available on-site 5-star accommodations of the Royal Cliff Hotels Group. ”

Chef Chumpol Chaengprai, Iron Chef Thailand

Pattaya Food and Hoteliers Expo

“ Meeting professionals and organizers normally want a flexible venue with halls that can grow with their shows and exhibitions and knowledgeable approachable staff to support them with their every need. Not only that, it has to be in a central and accessible location where organizers and delegates can have lots of networking opportunities in a safe and beautiful location. PEACH is a full-service venue in a stunning location that is especially favorable for regional and international events. With plenty of accommodations nearby and an exceptional professional staff, it is definitely an ideal meetings and event destination in Thailand. ”

Mrs. Vichaya Soonthornsaratoon, Director

Thailand Convention and Exhibition Bureau (TCEB)

“ While we conduct meetings across the world, Royal Cliff and PEACH established the standard we will strive for in the future. Its attention to detail and the little nuances have set a standard that will be hard to follow. With regards to the PEACH staff, they were professional and patient with our many demands and changes. They went way above the call of duty to satisfy any request that was made enabling them to significantly contribute to the overall success of our program. Many of our distributors said that the event in Thailand was the best ever and we owe those comments to the venue and the staff. ”

Mr. Paul Odom, Procurement and Planning Analyst

Jeunesse Expo – Annual World Conference



Diversity

Our talented staff comes from diverse backgrounds and nationalities. This is a place that truly embraces diversity.

Notes



Awards

Since its inception in 1973, the Royal Cliff Hotels Group has been honoured with multiple awards and recognition from prestigious organisations from around the world. Our legendary history and fame is impressively reflected in over 200 awards, accreditations and accolades we have received throughout the years in different categories. These recognitions are a testament to our high standard of hospitality and service that go beyond our guests' expectations.

- Elevated to the TTG Travel Hall of Fame
- TripAdvisor Travelers' Choice Award (only 1% of hotels in the world wins this award)
- Best Meetings & Convention Hotel from the Travel Trade Gazette (TTG)
- TripAdvisor Certificate of Excellence – www.tripadvisor.com
- The Kinaree; Thailand Tourism Award of Excellence for Convention Hotel and Tourist Accommodation from the Tourism Authority of Thailand (TAT)
- "Accolade Award" by CIM Magazine Australia
- Best Convention Hotel in Thailand by the International Hotel Awards in association with HSBC
- "Award of Distinction" by Trade Exhibition Association of Thailand (TEA)
- "Award of Excellent Service" by Thailand Incentive & Convention Association (TICA)
- Green Planet Award by Kuoni Travel, Switzerland
- Best Green Hotel recognition by www.thebestgreenhotel.com - USA
- Best of Award of Excellence for food and wine



TTG Travel Hall of Fame



Our Partners



➤ International Congress & Convention Association (ICCA)

➤ Thailand Convention & Exhibition Bureau (TCEB)



➤ Thai Exhibition Association (TEA)

➤ Thailand Incentive and Convention Association (TICA)



➤ Tourism Authority of Thailand (TAT)

➤ Thai Hotels Association (THA)

Global Status

The Royal Cliff Hotels Group has enjoyed welcoming renowned individuals and various events since its inception.

India is one of our main supporters and we have welcomed many popular superstars such as Sanjay Dutt, Ajay Devgun, Shreyas Talpade, Arshad Waarsi, Tusshar Kapoor, Rishi Kapoor, Jacky Bhagnani, Kareena Kapoor, Kangana Ranaut, Kajol, Reetu Kapoor, Celina Jetly, Amrita Arora, Malaika Arora Khan and Anjana Sukhani, just to name a few. We continue to attract popular Indian producers as an ideal choice for their Bollywood movies.

Asian Korean Pop idols have also shot numerous entertainment production with us. In 2011, SBS production chose the Royal Cliff to shoot their special edition program. Over 20 members of the most popular Korean bands stayed at the resort including 2pm, 2am, Shinee, Super Junior, T-ara, Big Bang, Secret, Sista, After School and Kara. To date, the resort is still very popular amongst Korean stars. On February 2014, PEACH hosted Thailand's biggest movie stars and A-list celebrities when it was the chosen venue for the spectacular 23rd Subhanahongsa Thailand National Film Association Awards organized by the Federation of Thai Film Producers. Other world renowned celebrities who have visited Royal Cliff in the past include: Roger Moore, William Hurt, Britt Ekland, Jonathan Phang and many more.

Aside from celebrities, numerous heads of states and Royal Families including the Royal Family of Thailand, Royal Family of Swaziland, Sultan of Brunei, U.S. President Jimmy Carter, the Prime Ministers of Singapore - Lee Kuan Yew and Lee Hsien Loon, President of South Korea - Lee Myung-bak, HRH Prince & Princess Akishino of Japan and many others have stayed at the resort.

We are also renowned for having one of the best sports facilities in the country and have attracted numerous sports stars. The Russian and Uzbekistan Davis Cup tennis team frequently stay at the Royal Cliff and set up their tennis camp at our sports center, Fitz Club - *Racquets, Health & Fitness*. Some of the top ATP players who have practiced at our tennis courts include Nikolay Davydenko, Denis Istomin, Mikhail Youzhny, Nicholas Kiefer and Paradorn Srichaphan. Aside from tennis stars, Andreas Mikkelsen, an Intercontinental Rally Champion (IRC) has also stayed here with his family.



Awards

Since its inception in 1973, the Royal Cliff Hotels Group has been honoured with multiple awards and recognition from prestigious organizations.

Notes

PEACH

PATTAYA EXHIBITION
AND CONVENTION HALL



“More than just a convention center, PEACH is a unique meeting destination that is set in a stunning location amidst tropical nature with breathtaking ocean views.”

PEACH

Pattaya Exhibition And Convention Hall

PEACH is one of the largest MICE venues outside of Bangkok and is the first of its kind in the Asia Pacific to use a resort - convention business model.

We can accommodate up to 10,062 delegates theatre-style and 4,340 seats for banquets. The main hall is flexible and can be divided into 4 large sections or 9 smaller sections, all adequately soundproof. There are also 18 smaller meeting rooms with various seating capacities ranging from 10 to 680 persons, which can be considered for breakout sessions, board meetings, training classes or discussion forums. Our flexible options allow the venue to host any type of event, from high-level conventions, meetings and exhibitions, product launches to concerts, gala events, weddings and banquets. With magnificent life-sized props and decorations, beautifully-adorned tables with impressive centre-pieces and an exceptional array of culinary creations, banquets at PEACH are a memorable experience.

Facilities @ PEACH

- Column-free halls
- Over 13,500 sqm of meeting space
- Ceiling height: 9.5m
- Organisers' offices
- 4 Hospitality Suites (VIP Rooms)
- Floor loading capacity
(Halls A,B and C : 2.5 tons per sqm & Hall D : 1 ton per sqm)
- Fast internet connectivity throughout the center
- Space for 446 booths (3 x 3m)
- 18 breakout rooms
- 4 control rooms
- 5 registration counters
- Overhead catwalk system (Halls A,B and C : 400 kg load & Hall D : 200 kg load per hanging point)
- 449 recess boxes (6m apart) with power, water and telecommunications outlets
- 6 drainage, gas and water outlets in the hall
- Complete wireless internet coverage
- Bonded warehouse facility
- Partnership with the best freight forwarders



PEACH

One of the largest MICE venues outside of Bangkok; this world class multi-purpose convention facility under the flagship of the Royal Cliff Hotels Group is the first of its kind in the Asia Pacific to be ideally set amidst nature.

Notes



MICE Services

Overview

With over 23,500 square metres of available meeting space, the Royal Cliff Hotels Group together with Pattaya Exhibition And Convention Hall (PEACH), is one of Asia's premier meeting, incentive and convention destinations. The centre can be arranged from a small boardroom meeting for 10 to a venue space for more than 10,000 delegates. We can organize live music, ice carvings, dance performances and grand fireworks to make your event more memorable.

Our extensive facilities located in the Royal Cliff Beach Hotel and Royal Cliff Grand Hotel include the Royal Summit Chamber and the Head of State Chamber (as well as numerous purpose-built meeting rooms for 30-150 people and excellent breakout facilities in both buildings).

A dedicated events manager and team are available to ensure the smooth, flexible planning and execution of your events. They can also suggest activities and scenic places to explore in Pattaya.

Completing our event facilities is a range of technological support including high quality audio-visual equipment, Wi-Fi internet connectivity and business centres. As a leading MICE venue, we take a step forward by offering the virtual and web conference option at Jomtien 1 which is located on the 1st floor of the Royal Cliff Grand Hotel.

PEACH was expertly designed to meet the demands of a 'hassle free' convention criterion. Its architectural design reflects all aspects of what sophisticated organisers and MICE delegates look for in a convention centre. With over 13,500 square metres of available meeting space, we offer delegates a range of options from large ballrooms and multiple break-outs to intimate boardrooms, generous pre-function spaces and built-in registration desks. Its main halls can host a wide range of events including tradeshow, exhibitions, product launches, concerts and many more. The main halls can be conveniently divided into four smaller sections: Hall A, Hall B, Hall C and Hall D. With soundproof walls and interlocking partitions, 4 large meetings can take place simultaneously. The 4 halls can be further sub-divided into a total of 9 separate sections.

Professional services are also available onsite for clients and event organisers. Standard services include high-speed internet, document scanning, coloured printing, faxing and photocopying. Whether you're planning for a convention, exhibition or a wedding, there is ample space as well as the necessary expertise and technology to ensure your event's success.

PEACH has 6 counters including an information counter, which provides space for public ticketing and registration. They have computer LAN cabling, telephone connections and paging facilities. They also have additional rooms at each end which are ideal for lockable offices. For organisers who require a registration desk directly in front of their allocated hall, we offer functional mobile registration desks designed to complement the ambience and décor of the event.

Meetings, Seminars & Conferences

Whether it is for small meetings, seminars or conferences, we are equipped with a comprehensive range of facilities to cater for different forms of settings and requirements. Meeting rooms can be booked individually, grouped with the operable walls removed for a plenary session or sectioned off for breakout areas.

Incentives

Our customized programs are thoughtfully and individually planned. They are characteristically created to suit an organiser's request so that high-achievers in every organization are recognized, awarded and motivated to do better. We are ready to ensure that our programs meet with your desired objectives by going that extra mile.

Team Building

Through experience, we know that people learn, retain, and bond best while having fun! We make sure that all of our team building activities are light-hearted and playful while focusing on 'relationship building' by getting people to interact with each other. We understand that for any organisation, employees make up the greatest asset representing a wealth of untapped potential. We are open to each organiser's individual requests for their respective groups and strive to guarantee that the objective of the exercise is achieved. We have multiple indoor and outdoor spaces to choose from, including beaches where beach volleyball can be played, to make your activities always interesting.

Exhibitions

Exhibitions at the Royal Cliff Hotels Group may be built-up and shown in multiple locations and these can range from extraordinarily large events to small scale business gatherings.

Our dedicated facilities can hold 446 standard exhibition booths with 449 recess boxes providing essential utility access namely; power, water, telecommunications and gas outlets. They are also installed with vehicular and display material access which is perfect for automotives, heavy machinery and product launches making us the ideal choice for serious exhibition organisers.

We also offer a large warehouse for storage purposes.



MICE Services

Whether it is for small meetings, seminars or conferences, we are equipped with a comprehensive range of facilities to cater for different requirements.

Notes

Weddings

at the Royal Cliff Hotels Group

We have proven to be a continually popular venue for weddings in recent years, due to our exclusive and scenic location, first class facilities, personalised service and professional staff.

Set along a crescent-shaped beach between Jomtien and Pattaya, we spare no detail in creating enchanting weddings. From the smallest, private ceremonies in an intimate outdoor setting, to the largest ballroom scale functions for 1,000 guests, we offer the support and facilities of 4 luxury hotels as well as an on-site convention hall that can accommodate over 10,062 guests. We also have the additional benefit of having professional staff with extensive wedding experience who strive to make every dream wedding a reality.

Food plays an important part for any wedding and at Royal Cliff Hotels Group, your wedding feast will be meticulously prepared by our renowned chefs. Offering a variety of menus, our culinary team will prepare a sumptuous banquet that showcases the very pinnacle of culinary perfection.

We can arrange many wedding styles including:



- Christian Wedding Ceremony
- Traditional Thai Buddhist Wedding Ceremony
- Indian Wedding Ceremony
- Secular Weddings (Non-Religious Ceremonies)

If you would like to customize your special day, please get in touch with our Romance Director by emailing: wedding@royalcliff.com.

Themed Dinners

Our professional expertise includes planning affairs that are nothing short of spectacular. Each theme is unique, exciting and designed to exceed expectations. A number of exciting shows can also be added to the program depending on the theme. From creatively decorated halls, elegant ballrooms, mesmerizing pools and beach areas to manicured gardens, your choice of a perfect venue to hold these themed dinners is endless.

A detailed program on our themed dinners can be made available upon request.

▶ **Pirate - Thrilling Adventure**

Step back to a time where eye patches were in fashion, treasure hunts were on the rise and life on a ship was normal! Pirate night is sure to please all your adventurous guests!

▶ **Loy Krathong - A Night of Beautiful Traditions**

Get your delegates to participate and experience the charm of Thai festivities. They will have a chance to create their own Krathongs and enrich their taste buds with traditional cuisine in this whimsical festival. This is best suited for groups who want to appreciate Thai culture.

▶ **Ancient Sukhothai - Experience Thailand's Golden Era**

With exquisitely designed temples and Thai art around you, the beauty and charm of this ancient era will come alive! We can arrange various Thai entertainment that includes long drum shows and classical dance performances.

▶ **Black and Gold - A Night of Elegance**

Spend the night surrounded by sophistication and style. This is best suited for your dinner conferences, award presentations or other special events. Black and Gold night is guaranteed to enchant your guests to the highest level.

▶ **Thai Temple Fair - Add Some Color to Your Night**

Thai temple fairs are vibrant affairs that celebrate local temples. With games such as darts and shooting galleries, traditional Thai performances and fair-inspired food, we will bring a real carnival experience to you and your delegates! This is best suited for groups who wish to do fun team building.

Spouse & Family Programme

At the Royal Cliff, a conference trip can also be a trip that involves the family. Our spouse & family programmes are designed to warmly welcome and provide interesting activities to every member of the delegate's family to keep them entertained.

We can customise a special package that appeals to individual tastes and interests. Options include learning traditional Thai cooking at Nah Pah - *Thai Cooking School*, shopping in Pattaya, visiting places of interest around the city, sailing in the Gulf of Thailand aboard our catamaran and many more!

For couples with children, our family-friendly team is happy to create an agenda that suits everyone. Children can enjoy the 'edutainment' activities offered at Funtasea - *Kids World*. Families can relax, hang out and play games at the Verge - *Games, Pool and Karaoke* or enjoy the facilities at Fitz Club - *Racquets, Health & Fitness*. From offering enjoyable activities and babysitting services to recommending popular Pattaya attractions, everything is taken into consideration.



Weddings

The Royal Cliff Hotels Group is a popular venue for weddings due to its exclusive and scenic location, first class facilities, personalised service and professional staff.

Notes

Beach Hotel : Meeting Facilities

	 U-shape style (Pax)	 Board room (I-shape) (Pax)	 Banquet (Pax)	 Class room (Pax)	 Theater style (Pax)	 Cocktail (Pax)	 Height in metres	 L x W in metres	 Area in m ² / ft ²
--	---	--	---	--	---	--	--	---	--

Royal Summit Chamber A+B	140	100	490	600	970	900	3	31 x 36	939 / 10,107
Royal Summit Chamber A	96	40	200	213	394	250	3	26.2 x 17.8	402 / 4,327
Royal Summit Chamber B	132	60	200	273	432	450	3	31 x 18.2	537 / 5,780
Sapphire A + B	54	50	100	72	120	120	3	20 x 6	120 / 1,291.6
Sapphire A	30	24	60	36	64	60	3	12 x 6	72 / 775
Sapphire B	18	24	40	24	48	30	3	8.5 x 6	51 / 549
Royal Opal Theatre Lower Level	45	30	140	214	140	240	4.1	12 x 21.7	240 / 2,583.3
Royal Opal Theatre Upper Level	-	-	60	66	100	60	2.8	6.8 x 25	250 / 2,691
Foyer A	-	-	-	-	-	250	-	-	600 / 6,458.3
Foyer B	-	-	-	-	-	150	-	-	420 / 4,520.8

All meeting facilities have Wi-Fi coverage.



Royal Summit Chamber



Royal Opal Theatre

Capacities & Dimensions

Room Scale

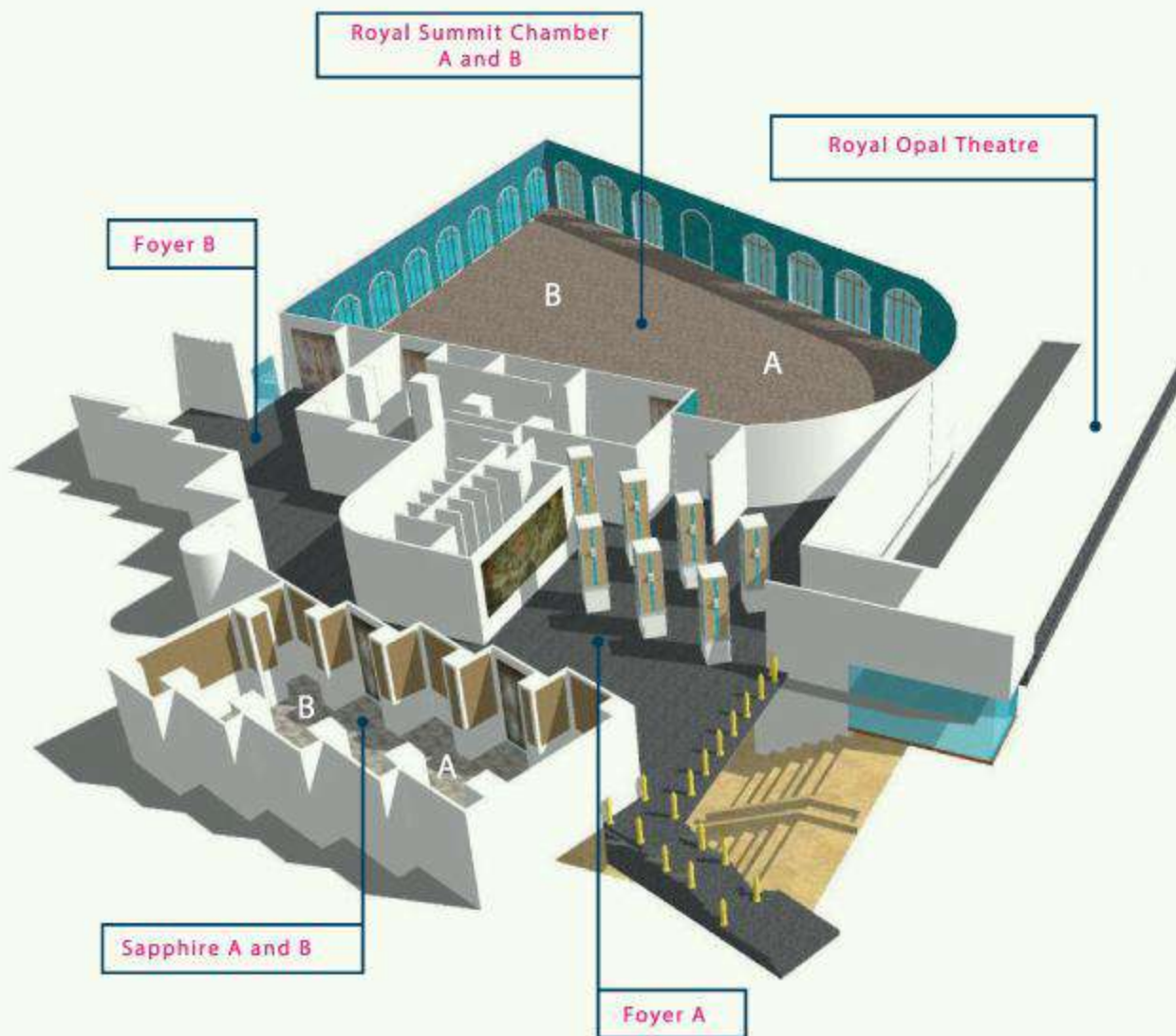

MICE Services

Floor Plans & Dimensions

▼ Beach Hotel

Notes

Beach Hotel : Meeting Facilities

Grand Hotel Lower Level 2 : Meeting Facility

	 U-shape style (Pax)	 Board room (I-shape) (Pax)	 Banquet (Pax)	 Class room (Pax)	 Theater style (Pax)	 Cocktail (Pax)	 Height in metres	 L x W in metres	 Area in m ² /ft ²
--	---	--	---	--	---	--	--	---	---

Jomtien 11	72	66	120	120	300	150	2.70	22.30x15.00	350
------------	----	----	-----	-----	-----	-----	------	-------------	-----

Grand Hotel 1st Floor : Meeting Facilities

	 U-shape style (Pax)	 Board room (I-shape) (Pax)	 Banquet (Pax)	 Class room (Pax)	 Theater style (Pax)	 Cocktail (Pax)	 Height in metres	 L x W in metres	 Area in m ² /ft ²
--	---	--	---	--	---	--	--	---	---

Orchid Ballroom A+B	120	72	250	324	480	350	3.45	22 x 25	550 / 5,920
Orchid Ballroom A	54	60	120	120	240	150	3.45	22 x 12.5	275 / 2,960
Orchid Ballroom B	54	60	120	120	240	150	3.45	22 x 12.5	275 / 2,960
Jomtien 1	27	24	40	45	72	50	2.85	10 x 8	80 / 861
Jomtien 2	30	36	50	54	90	70	2.5	13 x 7.5	98 / 1,055
Jomtien 3	24	30	40	45	70	50	2.5	11 x 7.5	83 / 893
Jomtien 4	21	24	30	24	48	40	2.5	10 x 5.5	55 / 592
Jomtien 5	21	24	30	24	48	40	2.5	10 x 5.5	55 / 592
Jomtien 6	21	24	30	24	48	40	2.5	10 x 5.5	55 / 592
Jomtien 7	21	24	30	24	48	40	2.5	10 x 5.5	55 / 592

All meeting facilities have Wi-Fi coverage.



Orchid Ballroom



Jomtien 1

Capacities & Dimensions

Room Scale

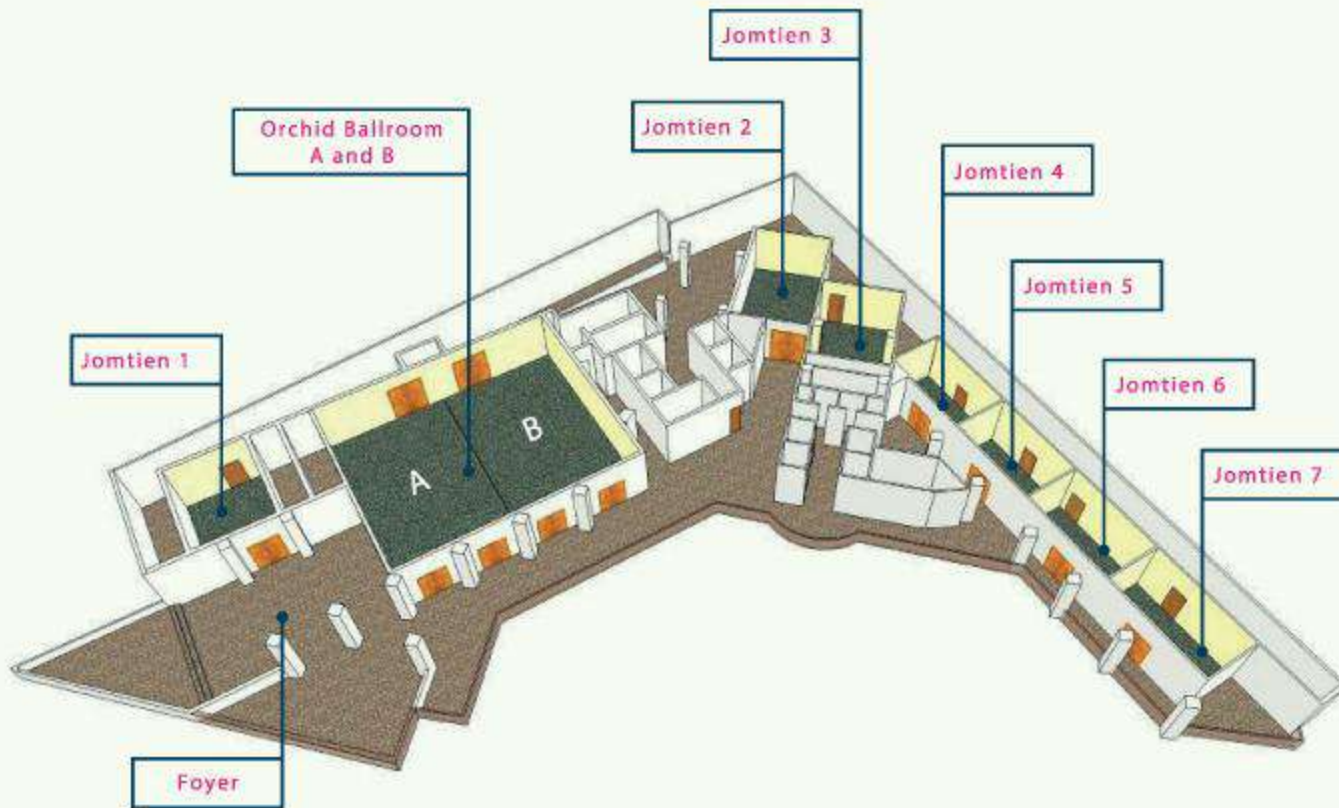

MICE Services

Floor Plans & Dimensions

→ 1st Floor - Grand Hotel

Notes

Grand Hotel 1st Floor : Meeting Facilities

Grand Hotel 2nd Floor : Meeting Facilities

	 U-shape style (Pax)	 Board room (I-shape) (Pax)	 Banquet (Pax)	 Class room (Pax)	 Theater style (Pax)	 Cocktail (Pax)	 Height in metres	 L x W in metres	 Area in m ² / ft ²
--	---	--	---	--	---	--	--	---	--

Head of State Chamber	138	66	300	315	500	400	5.1	30.5 x 18.5	564 / 6,071
Jomtien 8	24	30	50	45	70	70	2.8	11 x 7.5	87 / 936
Jomtien 9	18	24	40	36	60	50	2.8	9.5 x 7.3	69 / 743
Jomtien 10	27	24	50	48	84	70	2.4	10.4 x 9.7	100 / 1,076
Grand Deck	-	-	200	-	-	250	3	47 x 8	436.5 / 4,698
Grand Deck Terrace	-	-	150	-	-	200	3	19 x 22	381.18 / 4,103

All meeting facilities have Wi-Fi coverage.



Head of State Chamber



Head of State Chamber

Capacities & Dimensions

Room Scale

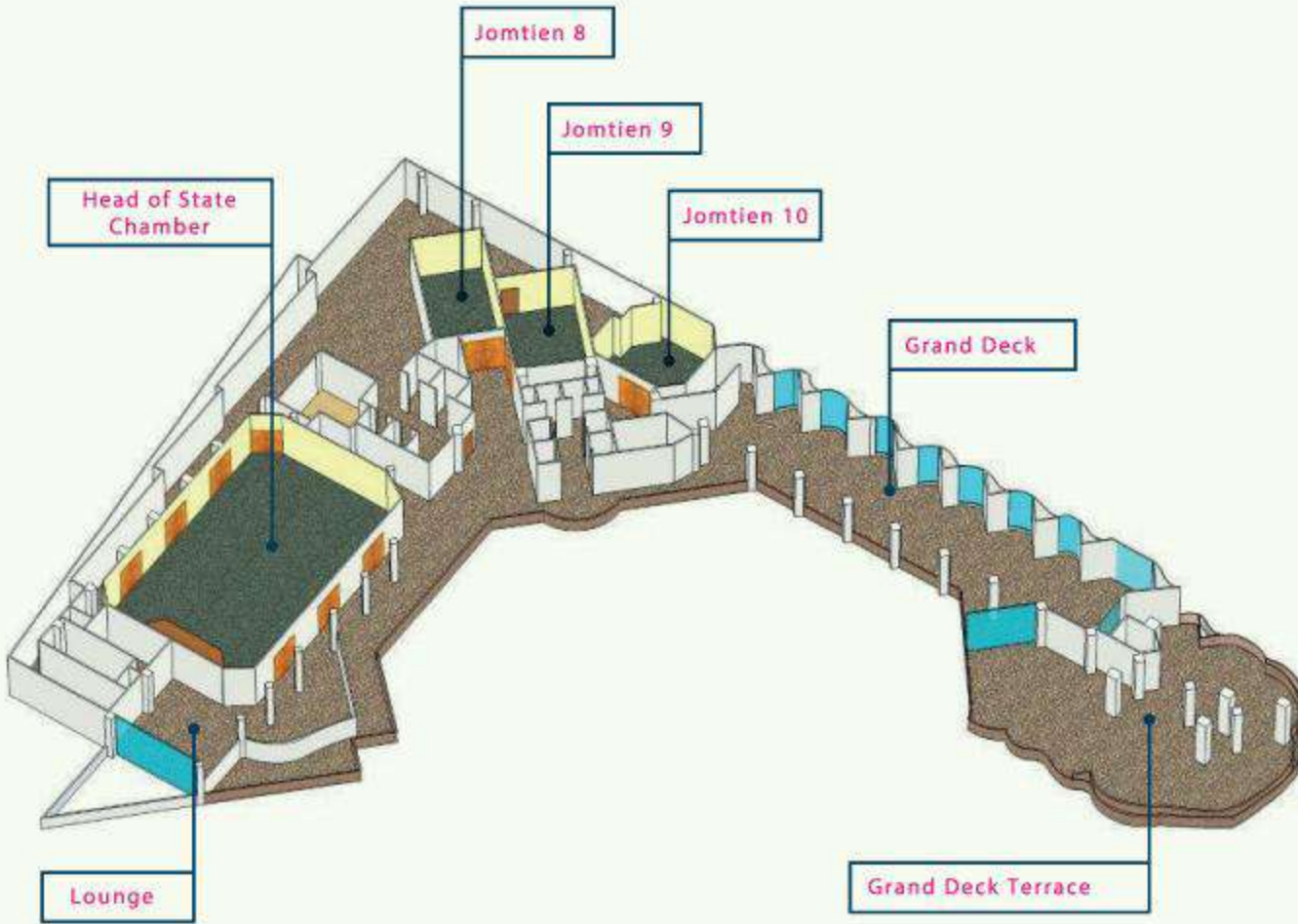

MICE Services

Floor Plans & Dimensions
▼ 2nd Floor - Grand Hotel

Notes

Grand Hotel 2nd Floor : Meeting Facilities

Capacities & Dimensions

Room Scale

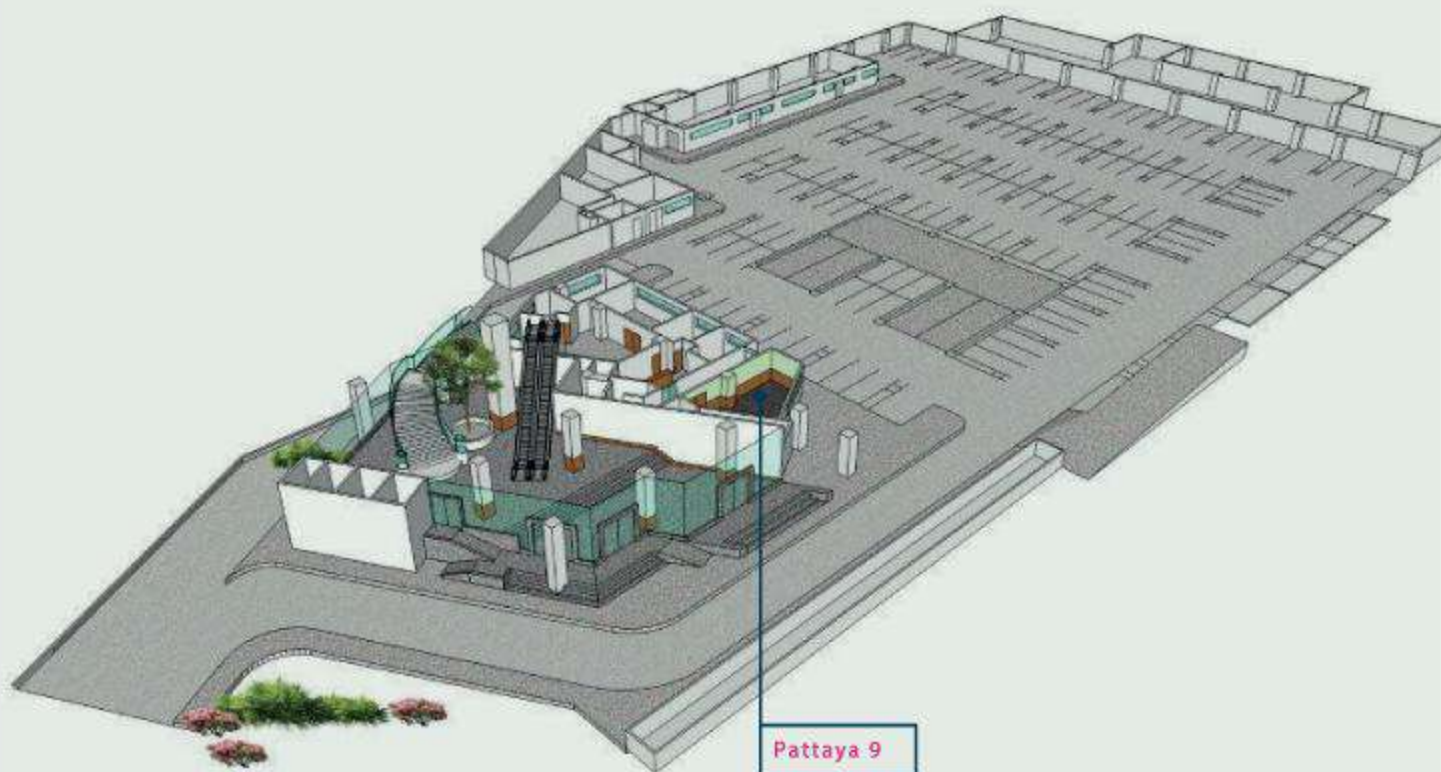

PEACH : Level 1

								
U-shape style (Pax)	Board room (I-shape) (Pax)	Banquet (Pax)	Class room (Pax)	Theater style (Pax)	Cocktail (Pax)	Height in meters	L x W in meters	Area in m ² /ft ²

Pattaya 9	27	30	30	36	62	50	2.2	11.8 x 8.6	68 / 732
-----------	----	----	----	----	----	----	-----	------------	----------

All meeting facilities have Wi-Fi coverage.

Capacities & Dimensions

Room Scale

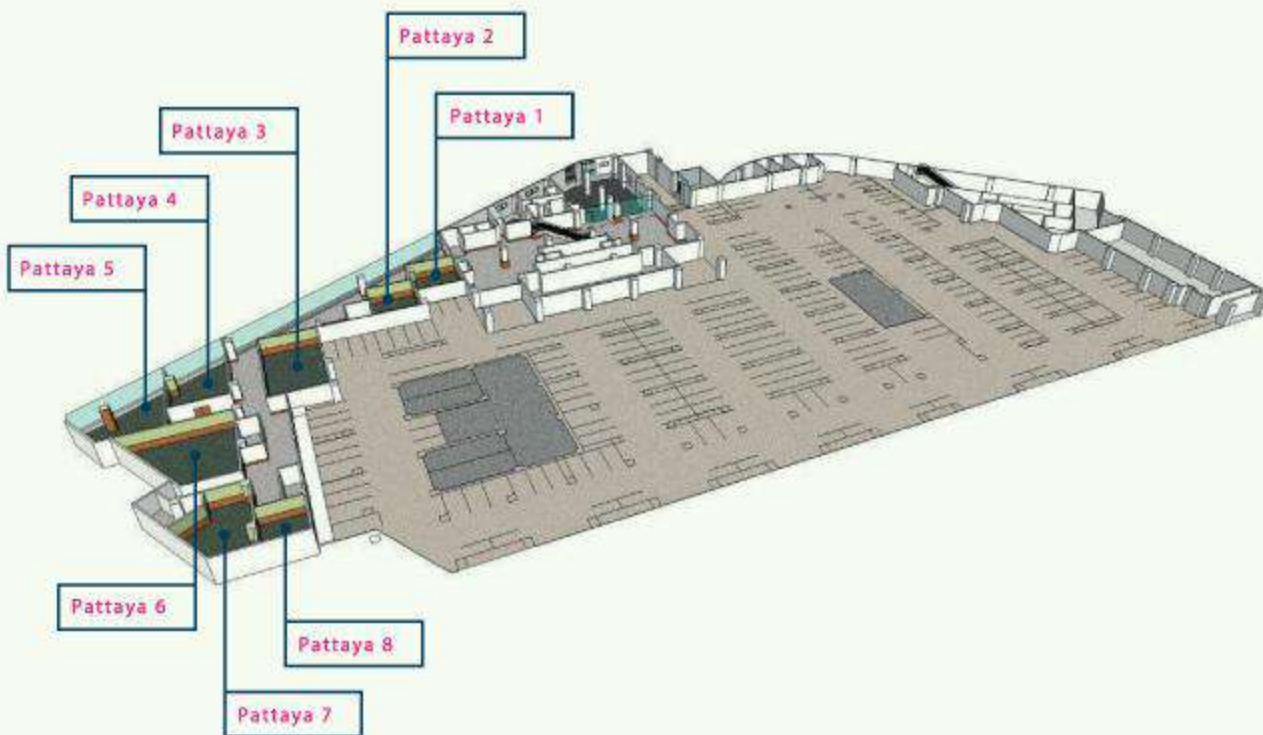

PEACH : Level 2

	 U-shape style (Pax)	 Board room (I-shape) (Pax)	 Banquet (Pax)	 Class room (Pax)	 Theater style (Pax)	 Cocktail (Pax)	 Height in meters	 L x W in meters	 Area in m ² /ft ²
--	---	--	---	--	---	--	--	---	---

Pattaya 1	27	24	40	36	72	60	2.4	9.8 x 8.8	84 / 904
Pattaya 2	24	24	40	36	60	55	2.4	9.2 x 7.8	72 / 775
Pattaya 3	42	48	80	108	144	110	2.4	16.3 x 8.4	134 / 1,442
Pattaya 4	30	30	60	45	99	80	2.4	15.0 x 8.8	109 / 1,173
Pattaya 5	30	30	50	54	70	90	2.4	13.6 x 12.4	110 / 1,184
Pattaya 6	36	42	80	63	110	110	2.4	14.8 x 11.2	143 / 1,539
Pattaya 7	33	36	50	42	84	70	2.4	12.9 x 9.7	90 / 969
Pattaya 8	15	18	10	18	24	30	2.4	6.7 x 6.0	38 / 409

All meeting facilities have Wi-Fi coverage.

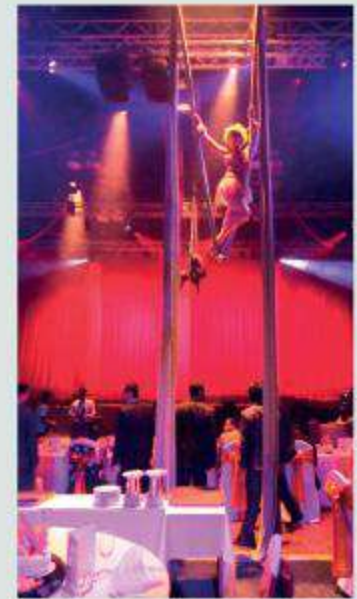

MICE Services

Floor Plans & Dimensions

- 1st Level - PEACH
- 2nd Level - PEACH

Notes

PEACH : Level 3

							
3m x 3m Exhibition booth	Banquet (Pax)	Class room (Pax)	Theater style (Pax)	Cocktail (Pax)	Height in meters	L x W in meters	Area in m ² /ft ²

Hall	3m x 3m Exhibition booth	Banquet (Pax)	Class room (Pax)	Theater style (Pax)	Cocktail (Pax)	Height in meters	L x W in meters	Area in m ² /ft ²
Hall ABCD	446	4,340	5,040	10,062	6,920	9.5	131.4 x 53.0	6,925 / 74,540
Hall A	93	700	936	1,452	1,560	9.5	53 x 30.3	1,568 / 16,878
Hall B	90	600	780	1,452	1,420	9.5	53 x 26.9	1,426 / 15,349
Hall C	146	1,000	1,404	2,376	2,370	9.5	53 x 44.9	2,380 / 25,618
Hall D	98	700	936	1,452	1,550	9.5	53.0 x 29.3	1,553 / 16,716
Hall AB	193	1,300	1,728	2,904	2,990	9.5	57.2 x 53	2,994 / 32,227
Hall ABC	333	2,760	3,600	5,600	5,370	9.5	102.1 x 53	5,372 / 57,824
Hall BC	258	1,800	2,400	4,440	3,800	9.5	71.8 x 53	3,805 / 40,956
Hall BCD	342	2,760	3,600	5,600	5,350	9.5	101.1 x 53	5,358 / 57,673
Hall CD	255	1,700	2,400	4,070	3,930	9.5	74.2 x 53	3,933 / 42,334
Hall A1	30	240	315	532	560	9.5	30.3 x 18.6	564 / 6,070
Hall A2	30	240	294	504	520	9.5	30.3 x 18.1	525 / 5,651
Hall A3	24	240	294	432	470	9.5	30.3 x 16.3	472 / 5,081
Hall C1	72	480	600	1,120	1,190	9.5	44.9 x 26.6	1,194 / 12,852
Hall C2	72	480	600	1,120	1,180	9.5	44.9 x 26.4	1,184 / 12,744
Hall D1	24	240	315	522	490	9.5	29.3 x 16.8	493 / 5,307
Hall D2	30	240	315	532	520	9.5	29.3 x 18	527 / 5,673
Hall D3	30	240	315	532	530	9.5	29.3 x 18.2	533 / 5,737

		
3m x 3m Exhibition booth	Banquet (Pax)	Area in m ² /ft ²

Area	3m x 3m Exhibition booth	Banquet (Pax)	Area in m ² /ft ²
Foyer	30	490	1,000 / 10,764
Terrace A	24	200	425 / 4,575
Terrace B	30	510	940 / 10,118
Coffee Shop	20	300	580 / 6,243
Pre - Function Area	30	400	730 / 7,858
Lift Lobby	6	80	235 / 2,530
Total	140	1,980	3,910 / 42,088

All meeting facilities have Wi-Fi coverage.

Capacities & Dimensions

Room Scale

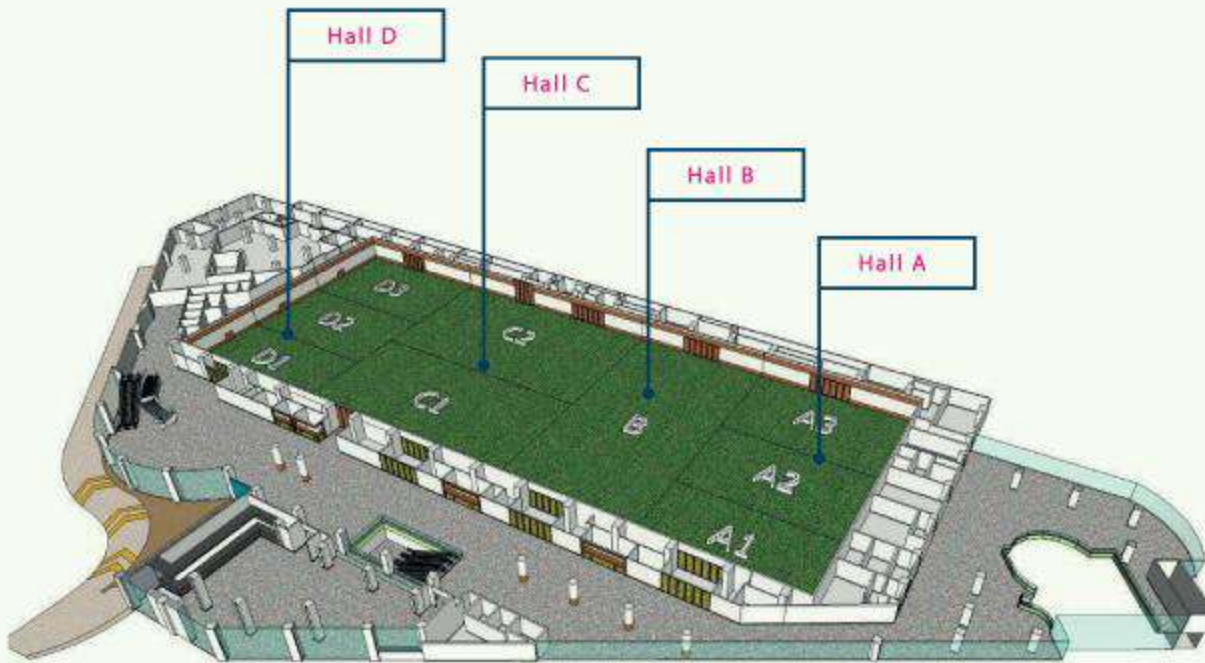

PEACH : Level 3



MICE Services

Floor Plans & Dimensions

→ 3rd Level - PEACH

Notes



Indian Wedding Set Up @ PEACH Hall



VIP Room @ PEACH



PEACH Hall ABCD



Exhibition @ PEACH



Loading and Unloading - Event Set Up



Kitchen @ PEACH

Capacities & Dimensions

Room Scale

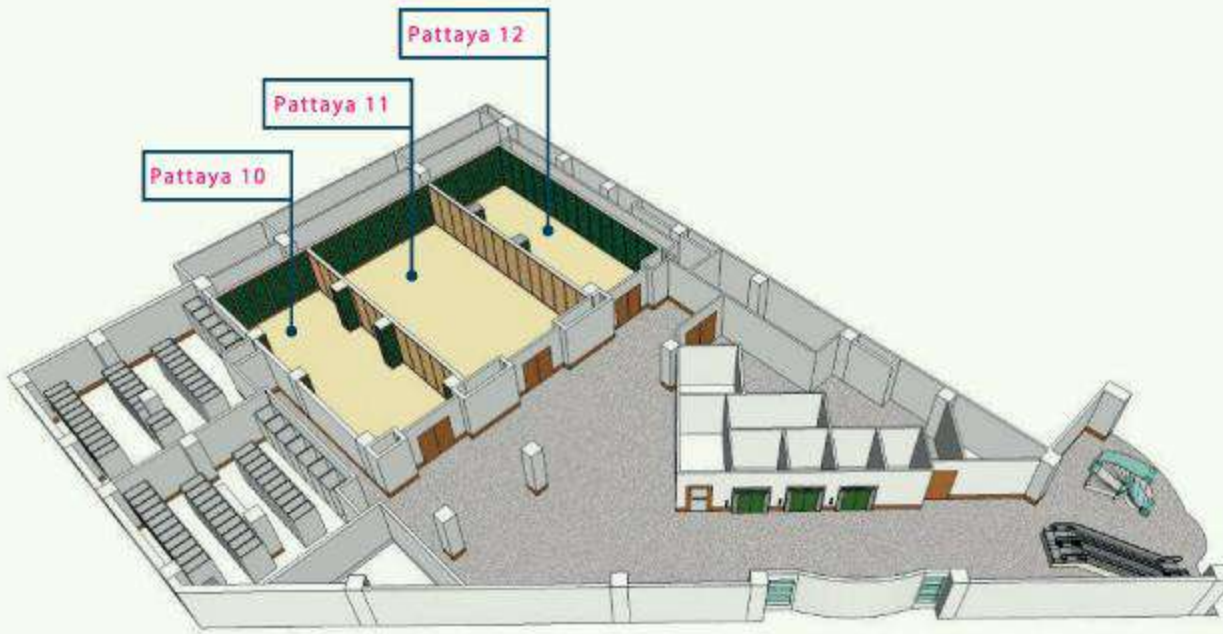

MICE Services

Floor Plans & Dimensions
 ↳ 4th Level - PEACH

PEACH : Level 4

	U-shape style (Pax)	Board room (I-shape) (Pax)	Banquet (Pax)	Class room (Pax)	Theater style (Pax)	Cocktail (Pax)	Height in meters	L x W in meters	Area in m ² /ft ²
--	---------------------	----------------------------	---------------	------------------	---------------------	----------------	------------------	-----------------	---

Pattaya 10	48	66	100	108	204	150	2.7	21.7 x 10.1	203 / 2,185
Pattaya 11	48	66	100	144	272	185	2.7	21.7 x 10.3	216 / 2,325
Pattaya 12	48	66	100	108	204	150	2.7	21.7 x 9.6	194 / 2,088

All meeting facilities have Wi-Fi coverage.

Notes

Capacities & Dimensions

Room Scale



East Lobby : Level 5

								
U-shape style (Pax)	Board room (I-shape) (Pax)	Banquet (Pax)	Class room (Pax)	Theater style (Pax)	Cocktail (Pax)	Height in metres	L x W in metres	Area in m ² /ft ²

East Lobby	-	-	550	-	-	1,000	3.9	73 x 22	1,080 / 11,625
------------	---	---	-----	---	---	-------	-----	---------	----------------

All meeting facilities have Wi-Fi coverage.

Outdoor Venue

								
U-shape style (Pax)	Board room (I-shape) (Pax)	Banquet (Pax)	Class room (Pax)	Theater style (Pax)	Cocktail (Pax)	Height in metres	L x W in metres	Area in m ² /ft ²

Lotus Garden	-	-	550	-	-	1,000	-	144 x 26	2,900 / 31,215
--------------	---	---	-----	---	---	-------	---	----------	----------------

Note: We have multiple outdoor spaces to choose from including our private beaches and infinity pools. Meeting space dimensions and details can be found on page 47-48.

A c c o m m o d a t i o n s

We are home to 4 luxury hotels, each offering a sensory experience defined profoundly by its individual styles, charm and elegance - all presented in the State of Exclusivity and Fascination. We offer the perfect beachfront setting featuring traditional Thai style furnishing with a touch of modernity, extraordinary service and the ambience of absolute luxury. Every accommodation is within walking distance to the convention centre.

R o y a l C l i f f B e a c h H o t e l

Casual Luxury

Located at the heart of the property providing exceptional value for money, the vibrant and fresh Royal Cliff Beach Hotel is ideal for families, friends and big groups. It offers a wide range of accommodation with all the benefits and facilities of a luxurious resort including a classic-designed swimming pool capped with an infinity edge pool and terrace area with panoramic views of the Gulf of Thailand.

457 rooms & 17 suites | 9 floors | 7 elevators
Mini Suite | Mini Suite Plus | Theme Suite (1 bedroom) | Theme Suite (2 bedrooms)

R o y a l C l i f f B e a c h T e r r a c e

Exotic Luxury

The Royal Cliff Beach Terrace is a mystical boutique hotel built into the cliff directly facing the sea. Its secluded beachfront location and tranquil atmosphere with easy access to the resort's trendy beach restaurant, Breezo - *Be Yourself Dining*, are perfect for a family holiday or romantic getaway. This exotic luxury style hotel will always enchant those who come across it.

64 rooms & 24 suites | 5 floors | 3 elevators
Honeymoon Deluxe | Family Suite (2 bedrooms)

Royal Cliff Grand Hotel

Formal Luxury

The Royal Cliff Grand Hotel accommodates every possible need of today's sophisticated traveler with its elegant design and modern features. Guests have exclusive use of its beautifully landscaped stunning 2-level infinity edge pool and sun decks. Recently upgraded, all rooms have been revamped with new interior teak furniture, lighting and a stylish bathroom design making it ideal for work and relaxation. Business travelers will enjoy the hotel's business center which is equipped with state-of-the-art amenities as well as the convenience of multiple meeting rooms. Whether you need it for work or leisure, the business centre is ideal to serve your purpose. This hotel is perfect for corporate meetings and incentives as each delegate can access multiple meeting rooms without having to leave the hotel.

342 rooms & 31 suites | 19 floors | 6 elevators
Grand Sea View | Grand Sea View Plus
Regency Suite (1 bedroom) | Regency Suite (2 bedrooms) | Royal Suite (2 bedrooms)

Royal Wing Suites & Spa

Ultimate Luxury

Completely upgraded, the luxurious all-suite Royal Wing Suites & Spa is recognised as one of the world's finest boutique hotels offering highly personalised service and attention. Exclusivity at the hotel also extends to its private free-form swimming pool set amidst beautifully landscaped gardens with reserved sun loungers and pool butler service. It always remains one of the top 3 rated hotels on TripAdvisor. Guests will be spoiled by the myriad of exclusive services on offer. Look no further, this is the ultimate hotel.

85 suites | 8 floors | 2 elevators
Royal Wing Suite (1 bedroom) | Presidential Platinum Suite (2-3 bedrooms)
Presidential Heritage Suite (3 bedrooms)



Accommodation

The Royal Cliff Hotels Group offers the perfect beachfront setting along with luxurious accommodations, extraordinary service and the ambience of absolute luxury.

Notes

Restaurants & Bars

At Royal Cliff Hotels Group, you have 11 of Pattaya's best restaurants and 6 stylish bars to choose from. Unsurpassed in its variety, quality and ambience, it is no wonder that most of the restaurants are winners of multiple coveted dining awards. Dining here is like embarking on a tour of the world's finest cuisines. The resort also provides Halal food prepared by our own certified Halal kitchen.

BREEZE O – Be Yourself Dining

Trendy beach restaurant & bar featuring innovative tapas selections and delicious seafood where cocktail lovers have an option to create their own-style cocktail

CAPRICE – A Taste of Riviera*

Fusion-style fine dining indulgence blending the different flavours from various European cuisine

CHAMU – Japanese Corner

A charming restaurant serving a variety of fresh sushi and traditional Japanese fare

HUANG CHAO – Royal Cantonese Cuisine*

An oriental delight serving elegant Cantonese specialties

LARN THONG – Authentic Thai Traditions*

Traditional Thai cuisine, bursting with tantalizing flavours, offering the best in local favourites. Every Saturday evening, guests can enjoy the BBQ buffet dinner

LA RONDE – Pool Sensation

A sensational oasis in the heart of the Royal Wing Pool offering international fare for lunch and delightfully refreshing beverages

MAHARANI – Queen of Indian Flavours**

Authentic Indian cuisine from the exotic regions of India

PANORAMA – Dramatic Atmosphere

International breakfast buffet and all-day dining restaurant offering international and regional favourites. The delicious dim-sum lunch is available on weekends.

ROSSINI & CIGAR LOUNGE – The Godfather's Favourite*

Renowned Italian restaurant offering a range of traditional home-made Italian dishes, an excellent wine list and an upscale cigar lounge which offers a large selection of imported cigars

Note: * Award-Winning Restaurant * Halal menu is available

ROYAL GRILL ROOM & WINE CELLAR – Excellence & Heritage*

Award-winning fine dining restaurant inspired by tradition and heritage which offers an astounding western menu and more than 1,000 wine labels from around the world

TERRACE @ Caprice

An alfresco dining outlet ideally set by the poolside, offering a la carte breakfast and the Caprice menu for the evening

WINE CAVERN @ Royal Grill Room & Wine Cellar

Ideal for a pre-dinner milieu or a relaxing interlude, it serves an exclusive tapas menu complemented by our recommended wines and champagnes

SUNSET TERRACE LOBBY & BAR

Positioned on the rooftop of the Royal Cliff Beach Terrace, it is one of the resort's gems worth exploring. This premier setting is inspired by the vision to create a modern yet comfortable area in which to enjoy the sunset, bask in the glow of twilight and indulge in tapas, wine and sensational cocktails.

THE BAR @ Royal Cliff Beach Hotel

The perfect retreat to relax whilst enjoying a favourite drink with live entertainment in the evening

THE BAR @ Royal Grill Room & Wine Cellar

The perfect way to start the evening or to end one is to enjoy a drink in the comfort of an opulent setting accompanied by our resident pianist

THE BAR @ Royal Cliff Grand Hotel

A cosy niche with amazing views of the sunset and the perfect venue to savour innovative cocktails while enjoying live entertainment in the evenings

THE BAR @ Caprice

Tranquil and serene, with a touch of elegance, enjoy a quiet drink as you relax in an elegant and beautiful setting

THE BAR @ Grand Infini Pool

Relax while enjoying the fresh coastal breeze with a refreshing cool drink



Restaurants & Bars

11 award-winning restaurants
and 6 stylish bars

Notes

Recreational Activities

Our host of recreational and leisure activities ensure that delegates are able to maintain a dynamic and healthy lifestyle even on a business trip and away from everyday routine. Incredible options are available within the property for meeting attendees or for those accompanying them on their events. Our activities have been created to entertain, educate, engage and excite.

Nah Pah-Thai Cooking School

Learn how simple it is to cook delicious local favourites. Our cooking classes offer an ideal home-style learning environment with the guidance of our master Thai chefs. We have a nursery herb garden where participants can pick the freshest seasonal ingredients for their dishes. Discover the uniqueness of uniting various herbs and spices and join us for a culinary adventure delightfully exploring Thailand's traditional cuisine!

FITZ CLUB-Racquets, Health & Fitness

Our health and fitness centre houses a state of the art gym with equipment for fitness training, toning, strength building and cardiovascular exercises. The club recently installed 16 brand new cardiovascular exercise machines which feature an iPod dock and cable TV. These are ideal for a good workout and are complemented by the availability of the sauna and steam rooms, free-form swimming pool and table tennis – all in a healthy natural environment.

Studio/Aqua Aerobics

Get in shape and stay healthy with our aerobic & fitness classes that are available to help you achieve your individual goals.

Thai Boxing (Muay Thai) Lessons

We invite guests to learn Thailand's celebrated and ancient martial art. A private instructor can be arranged upon request.

Tennis and Squash

With our 7 plexipaved Tennis courts of Grand Slam standards and 2 air-conditioned Squash courts, you are sure to have the best Tennis and Squash experience right here at the resort! Qualified coaches for Tennis are available for individual or group coaching. Tennis camps for children and adults can also be arranged.

Funtasea-Kids World

Funtasea - *Kids World* is the best “edutainment” centre in Pattaya. With over 200 square meters of indoor play area and featuring a wealth of interactive resources, toys and fun activities that stimulates creativity and imagination, it is a modern interactive environment for children between 2-11 years old. With an exciting selection of activities to enjoy and a fun, dynamic space for the little ones to explore, Funtasea is a perfect kids zone and a great way for parents to indulge in a memorable and worry-free vacation!

The Verge-Games, Pool and Karaoke

Featuring interactive elements such as game stations, pool table and a new karaoke lounge, this is the perfect place to kick back, relax and spend an exciting day with your family and friends. Offering the latest video game consoles including the popular Xbox 360, Kinect, Playstation 4 and Nintendo Wii along with an extensive list of popular songs in different languages, enjoy our endless entertainment options right at the hotel!

Exclusive Beaches

We are the only resort in Pattaya with 2 private beaches reserved exclusively for our hotel guests. For those who love photography, our beaches offer the best view of the surrounding islands. You can enjoy the cool breeze, play beach volleyball, soak in the sun and relax with your favorite cocktail. The beaches can also be used for events, dinner functions and special occasions. Food can be ordered from Breezeo - *Be Yourself Dining*, our popular beachside restaurant. Water sports and activities including sailing, wind surfing, jet skiing, banana boat rides and para-sailing can be arranged.

Health & Wellness

Cliff Spa

Enjoy the finest treatments and therapies carefully selected from around the world in our Cliff Spas located at the Royal Cliff Grand Hotel and the Royal Wing Suites & Spa. With 18 luxurious treatment suites, take this opportunity to soothe away your stress or simply spoil yourself in total relaxation in tranquil surroundings.

Beautique (Beauty Salon)

Located between the Royal Cliff Beach Hotel and the Royal Wing Suites & Spa, this beauty salon provides an excellent range of treatments including hair dying, hair braiding, acrylic nail service, manicure, pedicure, waxing, facial massage and our famous foot spa. Multiple treatments can be arranged at the same time, such as having your nails done while you are doing facial treatments. Beautique was recently redesigned to offer our guests a chic, modern, spacious and comfortable ambience.



Recreational Activities

Our recreational and leisure activities ensure that delegates are still able to maintain a healthy lifestyle even on a business trip and away from everyday routine.

Notes

International Benefits

We have the honour and privilege of welcoming guests from all corners of the world. Our renowned benefits have been established with our international clientele in mind and we make every effort to recognise every need. In order to ensure their comfort in a new environment and country, we have a range of amenities and services in place so the familiar is never far away.

Our multi-lingual staff have completed cross cultural training to increase their ability to best serve each guest and are ready to bridge language barriers to increase communication efficiency.

Collaterals are made available in different languages upon request.

Safety & Security

Our safety and security team has made every effort to create contingency plans and undertake procedures to minimise all safety risks to our guests. We have developed very strong working relationships with the local law enforcement and fire brigade to achieve our high safety standards.

- A high standard security control room and trained staff patrolling the entire premises
- Every precaution is taken in the event of fire with smoke and heat detectors as well as sprinklers in all rooms, emergency water supply on-site along with fire hydrants and hose reels systems around the property. Fire emergency evacuation staircases and fire doors to isolate smoke are installed in all the buildings.
- Each property is installed with on-site generators.
- Emergency corridors are installed with emergency lights including public areas.
- Flashlights are provided in all guest rooms.
- We have an on-site clinic with resident nurses and a doctor available on call. The nearest hospital is approximately a 10-minute drive from the property.
- We maintain the highest standard of food hygiene. We have been certified with the Food Safety Management certificate which is issued in conjunction with the ISO 22000 accredited by the British Standard Institute. We are also implementing good manufacturing practice and a Hazard Analysis and Critical Control Points (HACCP) system according to the Codex Recommended International Code of Practice – General Principles of Food Hygiene.

Special Needs Services

We recognise the needs of every guest including those with special needs and disabilities. Our facilities have been equipped with handicap-assistant features with all rooms and suites adaptable to special needs requirements.

- ▶ Trained staff to assist Special Needs guests and wheelchair users
- ▶ The availability of disabled-friendly rooms and suites
- ▶ All rooms & suites are adaptable to special needs requirements
- ▶ Lifts with Braille signage to all floors
- ▶ Door peephole height adjusted for wheelchair users
- ▶ Portable wooden ramps for access to rooms and restaurants as well as around the premises
- ▶ Swimming pool with safety rails
- ▶ All hotel restrooms are fitted with 'special needs' facilities
- ▶ Permanent wheelchair ramps on road walkways within the premises
- ▶ Hearing aid equipment upon request
- ▶ Reading glasses provided at restaurants
- ▶ Security features to ensure Special Needs guests feel safe at all times (CCTV located around the property)

Our staff will attempt to anticipate your every need whilst also respecting your independence. If you need anything at all, please let us know your requirements and we will strive to meet your request.



Special Needs Services

We recognise the needs of every guest including those with special needs and disabilities.

Notes

Pattaya, Thailand

Only 1 hour drive from Bangkok, Pattaya has long been the favourite getaway destination for local residents and visitors to Thailand. Over the years, it has become a home to an ever expanding growth of businesses and related services. The city still retains much of the charm and tranquility of the past while offering all the vigor, multicultural diversity and conveniences of a modern city.

Thailand is a country brimming with magnificent wonders and showcases a culture filled with time-honoured traditions along with the spirit of genuine hospitality. The vibrant and kind personalities of the Thai people have touched the hearts of all visitors. The country's beauty will always mesmerise and entice the imagination of every MICE organiser.

Local Attractions

Tap into local sights-and-sounds and experience the pleasure Pattaya has to offer! As a vibrant city, it has something for everyone. Book a private excursion on Royal Cliff's catamaran and travel to any of the surrounding islands for snorkeling, sunbathing or kayaking! Families can bring their children to various waterparks which feature exciting rides for all ages. Nightlife and shopping are always exhilarating. Our professional and knowledgeable staff will be able to best guide your choices and make sure that you are headed in the right direction. For sightseeing around Pattaya, we partner with the best attractions and have negotiated the best rates along with exclusive benefits for our clients. Our tour operator located at the Royal Cliff Grand Hotel will also be happy to assist you. Please ask our team if any of the below attractions interest you.

Family-Friendly Attractions

Khao Kiew Open Zoo

The open zoo has a large number of animals such as deers, bulls, monkeys, gibbons, bears, kangaroos, elephants and peacocks. Visitors can stroll around the grounds and observe the animals closely. There is also a large aviary with hundreds of varieties of birds that visitors can enter for close viewing.

Million Years Stone Park & Crocodile Farm

The compound is comprised of rock gardens, a botanical garden of rare plants and beautifully landscaped grounds. Interesting sights include fossils of plants over a million years in age, a 200 year old Thai Bonsai, a crocodile farm, and a collection of rare animals such as albino bears, elephants and horses. Crocodile round-ups, magic shows and animal performances are also major attractions.

Underwater World

Have a firsthand look at the wonders of Thailand's natural treasures. Underwater World features a collection of marine life from the Gulf of Thailand with a 105 metre long tunnel divided into 4 zones. There are educational activities featuring conservation of marine life and their natural habitats as well as live feeding demonstrations in every zone.

Art in Paradise

Fancy snaps of yourself over raging waterfalls and on board flying magic carpets? Have fun with three-dimensional paintings that are interactive and funny at the popular family-friendly Art in Paradise attraction. Treat loved ones to an exciting day of discovery spending a few hours snapping fun photos with various optical illusion artworks that will be sure to create the memories of a lifetime!

Ripley's "Believe it or not" Museum

Mr. Ripley's collections of curious objects from every corner of the world are on display. These extraordinary objects are divided into over 250 categories, such as optical illusions, peculiar lifestyles of unusual people and devices of torture from ancient times. It is located on the third floor of the Royal Garden Plaza.

Scenic & Cultural

Floating Market

You can go to one of the biggest floating markets in the eastern region, with more than 100 boutique-shops selling native food and specialties from the 4 regions of Thailand. The compound also features rice farming, sunflower fields, wood carving museum, boat rides to enjoy the view, Thai classical dances and martial arts demonstrations.

Sanctuary of Truth

Built in the Chaturamuk and Ayutthaya style and made completely of wood, it is considered one of Thailand's architectural marvels. It stands in Pattaya as a memorial to reflect Buddhism and the artistic vision of mankind.

Elephant Village

Visitors are welcome to learn the way of life and interdependence between villagers and elephants. Activities include elephant feeding and training, along with elephant riding, trekking, rafting and carting.

Kaan Show

The Kaan Show Theater showcases a spectacular cinematic live experience which is the first in Asia to combine the acrobatic skills of Cirque Du Soleil, artificial intelligence, projection mapping and robotics. Inspired by famous Thai literatures, including the Ramayana, Phra Apai Mani, Krai Thong and many more, the show seamlessly combines these epic stories into one. Storytelling is told through the use of world-class technology and special effects that will leave audiences in awe.

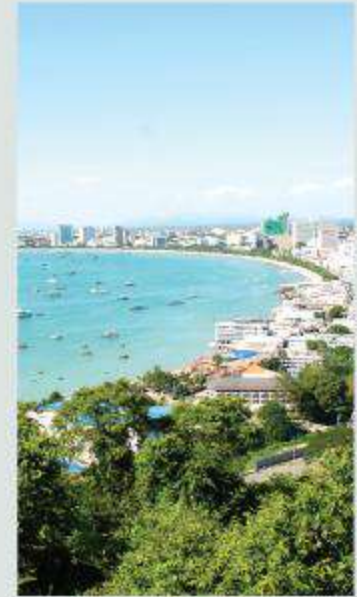

Pattaya, Thailand

A vibrant city with a lot to offer, Pattaya has long been the favourite getaway destination for local residents and international visitors.

Notes

Nature & Adventure

Horseshoe Point Club

This club is a gathering place for riders from all over the world to relax with friends and family as well as do horseback riding at all levels. This includes riding in the ring, the race-track, dressage and the adrenaline rush of jumping through a cross country course. It also offers an international standard polo field for new horse enthusiasts.

Diving & Snorkeling

PADI certified diving instructors are on hand to guide beginner and amateur divers through the basics of scuba diving. This could be an exhilarating adventure for those of you who wish to experience and pursue the world under the sea!

Pattaya Kart Speedway & Paintball Park

The Pattaya Kart Speedway contains a spacious site divided into segments for "Go Kart" races and practice which is targeted especially for newcomers and advanced drivers. They have some of the fastest karts in Pattaya. The paintball field is situated next to the go kart site. Suits, guns and paintballs are provided at a good value.

Cartoon Network Amazone Waterpark

No one does action and adventure better than Cartoon Network Amazone! Experience some of the fastest water rollercoasters in the world as you hurtle down to a splash landing from a massive 23.4 meter high tower or summon all your courage and get your g-force on with their 17 meter vertical free-fall.

Ramayana Waterpark

Ramayana Waterpark is located only 10 minutes from Pattaya beach within the natural beauty of the Silverlake area. Natural lakes and hills and an amazing scenery will make your visit a unique experience. Enjoy thrilling water rides, float in the lazy river, relax in a private cabana or savor a unique food experience for a fun and memorable day out with family and friends.

Sports

Golf

For avid golfers, Pattaya offers a wide range of world class golf courses, where most have been designed by some of the world's top names such as the Jack Nicklaus golf course. Royal Cliff is within half an hour drive from the best golf courses in the Eastern Seaboard.

Squash & Tennis

Royal Cliff has the best racquets club in Pattaya, Fitz Club. All hotel guests can enjoy playing on professional glass back squash courts and Grand Slam standard Tennis Courts. Coaching and knockers are also available at the club.

Water Sports

From jet skiing, sailing, parasailing, windsurfing and even fishing, Pattaya has a treasure trove of thrilling water-based activities.

Islands & Beaches

Koh Krok

A small island with a sandy beach on the east end, this is an ideal place for coral viewing.

Koh Larn (Coral Island)

Koh Larn is composed of a large group of islands with beautiful beaches, clear water and an abundance of coral.

Monkey Island

Pattaya Monkey Island is a hidden gem where you can feed and swim with native Samae monkeys in white sandy beaches.

Pattaya Beach

A lively and exhilarating beach scene, most of its shoreline is near department stores, boutiques, beauty salons, supermarkets, bars, restaurants and night clubs. It is the perfect place to relax before moving on to do other fun activities.

Jomtien Beach

This quiet family beach is popular with windsurfers and water sports enthusiasts. Come and enjoy the fresh breeze as you spend a relaxing day taking in the mesmerizing views of the horizon and the sea.



ISLANDS AND BEACHES

Pattaya's pristine islands offer beautiful beaches, clear water and amazing sunsets. They are excellent places for swimming, snorkeling and sunbathing.

Pattaya Monkey Island is a hidden gem where you can feed and swim with native Samae monkeys in white sandy beaches.

Notes

Shopping

Pattaya has a fabulous range of shopping and entertainment destinations. Featuring brand-name department stores to interesting street markets catering to locals and tourists alike, it is considered a shopping paradise. Night markets are also a common sight and a bargain-hunters' delight.

Central Festival

Featuring popular shops from all over the world, it is Asia's largest beachfront shopping mall. It is the flagship shopping destination in Pattaya and is popular for tourists and locals who flock here to buy branded clothing, eat in a variety of restaurants and enjoy world-class entertainment. With a beachfront location and glass-paneled façade, its modern ocean-facing design gives visitors a panoramic view of Pattaya Bay. Our shuttle to downtown Pattaya drops you off at its doorstep.

Mike Shopping Mall

As the first shopping mall in Pattaya, it is still the place to go for the best deals in town. Our shuttle to downtown Pattaya drops you off at its doorstep.

Harbor Pattaya

It features many shops and restaurants along with a lifestyle shopping mall, an IT center, a family edutainment center, large indoor playground, an ice skating rink, an education zone and a premium office building.

King Power Duty Free

Luckily for visitors, Pattaya has a duty free shop right in town. You can conveniently purchase all the delightful products found at the airport duty-free right here in the city.

Outlet Mall

Take a trip down the cliff and into shopping paradise. With popular brand names at factory prices, you cannot go wrong!

Local/Weekend Markets

Come and experience the local fresh food markets which are very popular in Thailand. Here, you can mingle with the locals, try new interesting food and get a sense of the flow of everyday life.

Entertainment

Pattaya offers a variety of entertainment - from upscale outlets to street bars or even cocktail caravans. The city's shopping scene and nightlife is second only to Bangkok. With its stylish bars, discos, cabaret shows and live entertainment along with world-class shopping destinations, visitors will never be bored!

The Jazz Pit Pub

Set amidst a Thai restaurant, the pub offers live jazz music with great food and drinks in a cozy atmosphere. Musicians and singers are welcome every Monday to join its weekly Jam session featuring a variety of jazz styles.

Gulliver's Pattaya

Gulliver's Pattaya is beautifully decorated and boasts a relaxing atmosphere. The bar serves Thai and western food along with a wide-ranging drink list. It is a great scene for a fun night out and an ideal place for watching sports.

Hopf Brew House

Hopf Brew House is a German beer bar & restaurant located on Beach Road. Their menu features German favorites such as pork knuckle and sausages. The venue is designed like a German brewery offering customers brew lager, wheat beer and dark beer. It has an in-house band that plays Pop & Rock.

Hard Rock Café

Hard Rock Café creates a cozy and beach-style atmosphere to hang out and watch the sunset or toast a fabulous night out with smooth rhythms ranging from Reggae to Latin music to 60s Surf Tunes.

-5° Icebar

You will experience an icy delight at the -5° Icebar. Winter coat and gloves are provided upon entry to the icy section, along with free vodka shots. Everything in the bar including the glasses, furniture and walls are made of ice. An adjacent bar with normal temperature serves great cocktails and a tapas menu.



Central Festival

Featuring popular shops from all over the world, it is Asia's largest beachfront shopping mall which is popular for tourists and locals who flock here to buy branded clothing, eat in a variety of restaurants and enjoy world-class entertainment.

Notes

Essential Facts

Airports

Thailand has 6 international airports located in Bangkok, Chiang Mai, Chiang Rai, Phuket, Hat Yai and Pattaya. The Royal Cliff Hotels Group and Pattaya Exhibition And Convention Hall (PEACH) are only 135 km (approximately 75 minutes by car) from Suvarnabhumi Airport, Bangkok and 40 km from Utapao-Rayong-Pattaya International Airport.

Climate

Thailand is a tropical and humid country with three seasons - hot from March to May, rainy from August to September (although it is usually sunny most of the day) and cool from November to February. Temperatures range from 35° C in April to less than 20° C in December.

Business Hours

- Government officials (e.g., immigration) open their desks at 9.00 a.m. Lunch is from midday to 1.00 p.m. and they close at 4.30 p.m.
- Banks open from 9.00 a.m. to 3.30 p.m. from Mondays to Fridays. Banks and government offices are closed on public holidays. Banks in major shopping malls are open until 8.00 p.m. daily.
- Opening hours for department stores usually start around 10.00 a.m. and close between 8.00 p.m. to 10.00 p.m.
- Smaller businesses are open from 8.30 a.m. or 9.00 a.m. until 5.30 p.m. or 6.30 p.m., while some family-run shops are open all day.
- Pubs and clubs are open from around 7.00 p.m. until the early hours – times differ.

Credit Cards

All major credit cards are widely accepted at restaurants, hotels, department stores and major tourist areas.

Currency

Thailand's currency is the Baht (THB). Notes are in denominations of 20, 50, 100, 500 and 1,000. Coins are in 1, 2, 5 and 10.

Electricity

Electricity in Thailand is 220 volts, alternating at 50 cycles per second. If you have a device that does not accept 220 volts at 50 hertz, you will need a voltage converter. Outlets in Thailand generally accept 2 types of plug: flat blade plug or two round pins.

Geography

Thailand covers an area of 514,000 km². It is located in the centre of Southeast Asia, just north of the Equator and bordered by Myanmar, Laos, Cambodia and Malaysia.

Language

The official language is Thai. English is widely spoken in the MICE and Tourism Industry particularly in hotels, meeting venues and major tourist areas. We have a multilingual team who can speak English, Thai, Japanese, Korean, Indian, Chinese (Mandarin), German and Russian.

Thai "Wai"

The wai is both a sign of respect as well as a greeting. It is done by putting 2 hands together like you are going to pray and bowing your head so that your head touches the tips of your fingers. Respect and courtesy are demonstrated by the height at which the hands are held and how low the head comes down to meet the thumbs of both hands.

Time Zone

Thailand is 7 hours ahead of Greenwich Mean Time (GMT +7)

Tourist Information

The Tourism Authority of Thailand provides a range of information for travellers. It has information centers that are located in major cities and international airports. Please visit their website at www.tourismthailand.org



Essential Facts

The Royal Cliff Hotels Group and Pattaya Exhibition And Convention Hall (PEACH) is the ideal venue for productive, stimulating and rewarding MICE engagements. Exceeding expectations is at the heart of our culture.

Notes



	U-shape style (Pax)	Board room (I-shape) (Pax)	Banquet (Pax)	Class room (Pax)	Theater style (Pax)	Cocktail (Pax)	Area in m ² /ft ²
Royal Cliff Beach Hotel - Meetings & Function Venues							
Royal Summit Chamber A+B	140	100	490	600	970	900	939 / 10,107
Royal Summit Chamber A	96	40	200	213	394	250	402 / 4,327
Royal Summit Chamber B	132	60	200	273	432	450	537 / 5,780
Sapphire A + B	54	50	100	72	120	120	120 / 1,291.6
Sapphire A	30	24	60	36	64	60	72 / 775
Sapphire B	18	24	40	24	48	30	51 / 549
Royal Opal Theatre Lower Level	45	30	140	214	140	240	240 / 2,583.3
Royal Opal Theatre Upper Level	-	-	60	66	100	60	250 / 2,691
Foyer A	-	-	-	-	-	250	600 / 6,458.3
Foyer B	-	-	-	-	-	150	420 / 4,520.8
Beach Infini Pool (Level 3-6)	-	-	2,000	-	-	2,500	-
Royal Cliff Beach Hotel - Restaurants & Bars							
Panorama Sea View	-	-	120	80	10	150	-
Panorama Pool View	-	-	200	-	-	-	-
Royal Grill Room & Wine Cellar	-	-	100	-	-	-	-
Maharani	-	-	60	-	-	100	-
The Bar @ Royal Cliff Beach Hotel	-	-	87	-	-	150	-
The Bar @ Royal Grill Room & Wine Cellar	-	-	-	-	-	24	-
Royal Cliff Beach Terrace - Restaurants & Bars							
Breezeo	-	-	60	-	-	100	-
Sunset Terrace Lobby & Bar	-	-	80	-	-	120	-
Royal Cliff Grand Hotel - Meetings & Function Venues							
Jomtien 1	27	24	40	45	72	50	80 / 861
Jomtien 2	30	36	50	54	90	70	98 / 1,055
Jomtien 3	24	30	40	45	70	50	83 / 893
Jomtien 4	21	24	30	24	48	40	55 / 592
Jomtien 5	21	24	30	24	48	40	55 / 592
Jomtien 6	21	24	30	24	48	40	55 / 592
Jomtien 7	21	24	30	24	48	40	55 / 592
Jomtien 8	24	30	50	45	70	70	87 / 936
Jomtien 9	18	24	40	36	60	50	69 / 743
Jomtien 10	27	24	50	48	84	70	100 / 1,076
Jomtien 11	72	66	120	120	300	150	350
Head of State Chamber	138	66	300	315	500	400	564 / 6,071
Orchid Ballroom A + B	120	72	250	324	480	350	550 / 5,920
Orchid Ballroom A	54	60	120	120	240	150	275 / 2,960
Orchid Ballroom B	54	60	120	120	240	150	275 / 2,960
Grand Deck	-	-	200	-	-	250	436.5 / 4,698
Grand Deck Terrace	-	-	150	-	-	200	381.18 / 4,103
Promenade Lounge & Terrace	-	-	150	-	-	220	-
Promenade Lounge	60	60	150	180	250	150	519
Promenade Terrace	-	30	50	-	141	70	141
Cliff Terrace Roof Top & Grand Infini Pool	-	-	240	-	-	300	-
Royal Cliff Grand Hotel - Restaurants & Bars							
Larn Thong	-	-	68	-	-	-	239
Larn Thong Terrace	-	-	120	-	-	-	411
Chamu	-	-	27	-	-	-	125
Rossini and Cigar Lounge	-	-	59	-	-	-	272
Rossini Poolside	-	-	40	-	-	-	147
Huang Chao	-	-	150	-	-	-	540
The Bar @ Royal Cliff Grand Hotel	-	-	72	-	-	-	290

U-shape style (Pax)	Board room (I-shape) (Pax)	Banquet (Pax)	Class room (Pax)	Theater style (Pax)	Cocktail (Pax)	Area in m ² /ft ²
---------------------	----------------------------	---------------	------------------	---------------------	----------------	---

PEACH

Hall ABCD	-	-	4,340	5,040	10,062	6,920	6,925 / 74,540
Hall A	-	-	700	936	1,452	1,560	1,568 / 16,878
Hall A1	-	-	240	315	532	560	564 / 6,070
Hall A2	-	-	240	294	504	520	525 / 5,651
Hall A3	-	-	240	294	432	470	472 / 5,081
Hall B	-	-	600	780	1,452	1,420	1,426 / 15,349
Hall C	-	-	1,000	1,404	2,376	2,370	2,380 / 25,618
Hall C1	-	-	480	600	1,120	1,190	1,194 / 12,852
Hall C2	-	-	480	600	1,120	1,180	1,184 / 12,744
Hall D	-	-	700	936	1,452	1,550	1,553 / 16,716
Hall D1	-	-	240	315	522	490	493 / 5,307
Hall D2	-	-	240	315	532	520	527 / 5,673
Hall D3	-	-	240	315	532	530	533 / 5,737
Pattaya 1	27	24	40	36	72	60	84 / 904
Pattaya 2	24	24	40	36	60	55	72 / 775
Pattaya 3	42	48	80	108	144	110	134 / 1,442
Pattaya 4	30	30	60	45	99	80	109 / 1,173
Pattaya 5	30	30	50	54	70	90	110 / 1,184
Pattaya 6	36	42	80	63	110	110	143 / 1,539
Pattaya 7	33	36	50	42	84	70	90 / 969
Pattaya 8	15	18	10	18	24	30	38 / 409
Pattaya 9	27	30	30	36	62	50	68 / 732
Pattaya 10	48	66	100	108	204	150	203 / 2,185
Pattaya 11	48	66	100	144	272	185	216 / 2,325
Pattaya 12	48	66	100	108	204	150	194 / 2,088
Pattaya 14	27	24	50	36	60	70	93 / 1,001
Pattaya 15	30	30	60	60	112	105	129 / 1,389
Pattaya 16	42	48	80	84	154	120	144 / 1,550
Pattaya 17	36	42	60	63	100	80	105 / 1,130
Pattaya 18	36	42	60	63	100	80	107 / 1,152
Pattaya 19	27	42	60	45	72	100	128 / 1,378
PEACH - VIP Rooms & Secretariat Office							
VIP 1	-	-	-	-	-	-	50
VIP 2	-	-	-	-	-	-	45
VIP 3	-	-	-	-	-	-	89
VIP 4	-	-	-	-	-	-	30
Secretariat Office	-	-	-	-	-	-	80
PEACH - Lobbies & Foyers							
Foyer	-	-	490	-	-	-	1,000 / 10,764
Terrace A	-	-	200	-	-	-	425 / 4,575
Terrace B	-	-	510	-	-	-	940 / 10,118
Coffee Shop	-	-	300	-	-	-	580 / 6,243
Pre - Function Area	-	-	400	-	-	-	730 / 7,858
Lift Lobby	-	-	80	-	-	-	235 / 2,530
East Lobby	-	-	550	-	-	1,000	1,080 / 11,625
Lotus Garden	-	-	550	-	-	1,000	2,900 / 31,215
Royal Wing Suites & Spa - Function Venues							
Beach Volleyball Area	-	-	120	-	-	200	645
Poolside	-	-	150	-	-	250	850
Royal Wing Suites & Spa - Restaurants & Bars							
Terrace @ Caprice	-	-	40	-	-	80	195
La Ronde	-	-	40	-	-	80	162
Caprice	-	-	72	-	-	120	380
The Bar @ Royal Wing Suites & Spa	-	-	-	-	-	40	210

For venues with no numbers for certain setups, we can still do the set ups upon request.
Please contact our sales managers at mice@royalcliff.com.

N o t e s

Thank You for Choosing the Royal Cliff Hotels Group and PEACH.









Getting in touch

PEACH's innovative and proactive team is always looking forward to hear from you. If you have any questions or would like to request for a proposal (RFP), please contact us via the following ways:

ROYAL CLIFF HOTELS GROUP

353 Phra Tamnuk Road
Pattaya, Chonburi 20150, Thailand
Tel : (+66) 38 250421 | Fax: (+66) 38 250511, 250513
mice@royalcliff.com | bkksales@royalcliff.com | www.royalcliff.com

PATTAYA EXHIBITION AND CONVENTION HALL [PEACH]

Tel: (+66) 38 250421 | Direct Tel/Fax: (+66) 38 250482
mice@royalcliff.com | bkksales@royalcliff.com | www.peachthailand.com

Website: www.peachthailand.com

Please go to "Contact Us" on the website and you will find more information about our team.
This page also has an option to fill in the RFP form.

“ It is our passion to make every event extraordinary. ”